

Spiralite

Glue-fix to beams

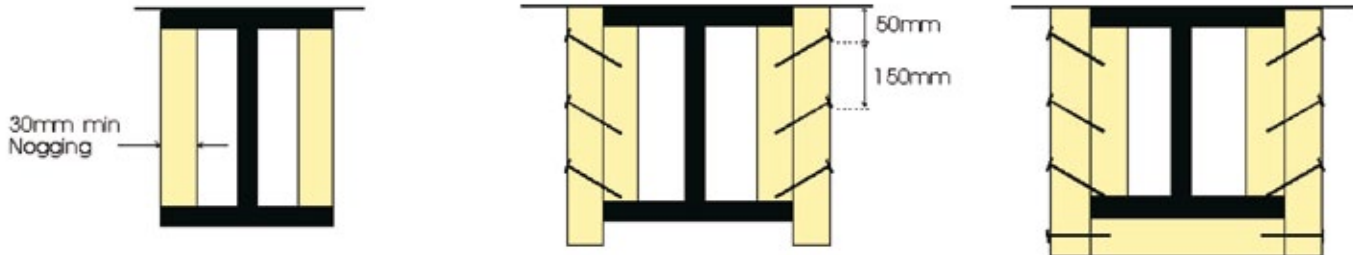
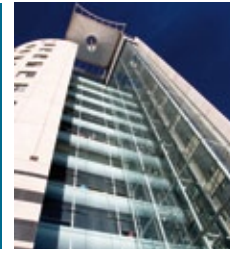

1. Push fit and glue 100mm wide noggings between flanges, flush with flange tips, at 900mm max centres.

2. Cut side panels equal to depth of section plus nominal thickness of board. Apply Rockbond WR to all board to board joints. Secure board with wire nails askew at 150mm max centres. (25mm from board edge at joint positions).

3. Cut soffit panel equal to width of lower flange. Apply Rockbond WR to all board to board joints. Secure soffit panel to sides with wire nails at 450mm max centres, 1/2 board thickness from lower board edge.

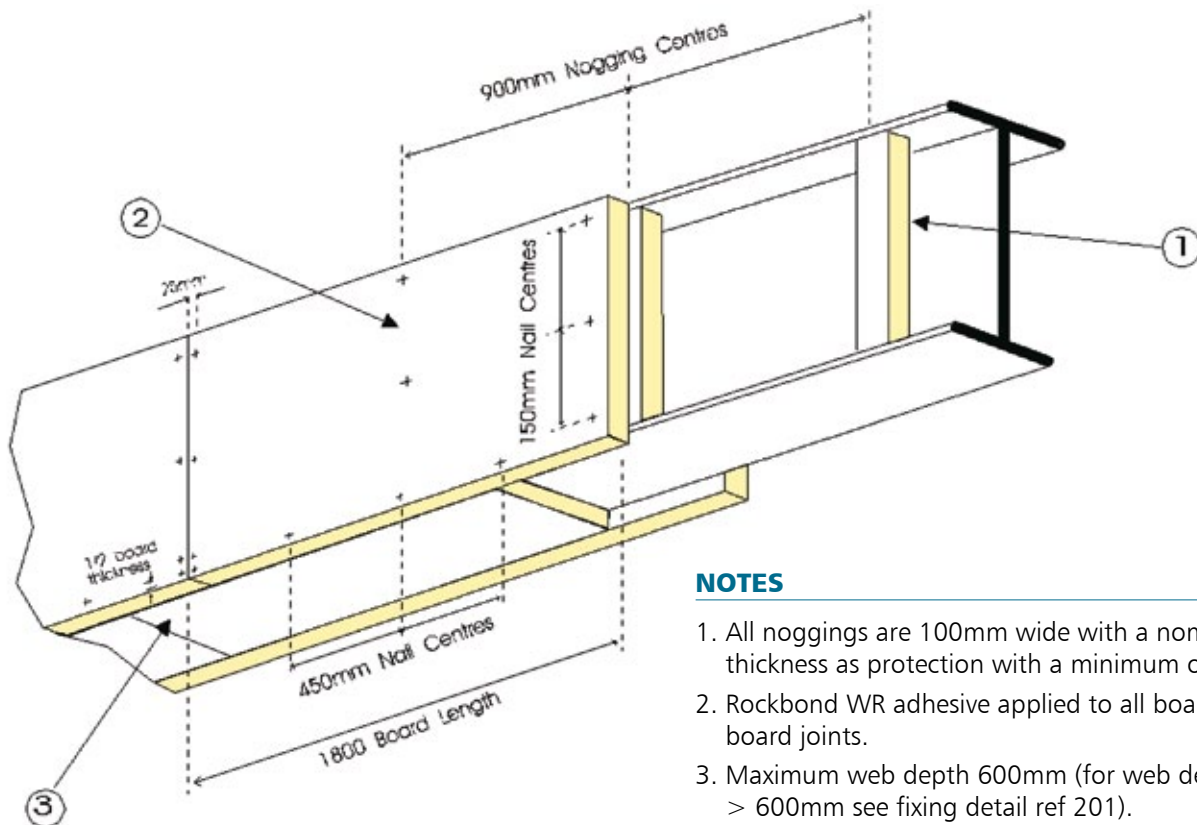

NOTES

1. All noggings are 100mm wide with a nominal thickness as protection with a minimum of 30mm.
2. Rockbond WR adhesive applied to all board to board joints.
3. Maximum web depth 600mm (for web depths > 600mm see fixing detail ref 201).
4. Maximum flange width 315mm (for flange width > 315mm see fixing detail ref 201).
5. Nogging to be placed on both ends of beam.

The information contained in Cryotherm data sheets is believed correct at the time of publication. Whilst we will endeavour to keep our publications up to date, readers will appreciate that between publications there may be pertinent changes in the law, or other developments affecting the accuracy of the information provided.

Date of this revision: 24/06/15