

Rockliner

Typical 3-sided snaplock casing

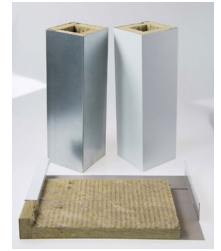

Fabricated in either a "U" shaped section or 3 pieces with snap-lock joints as shown.

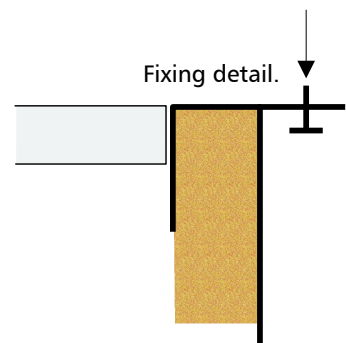
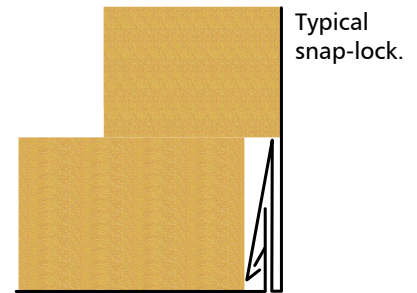
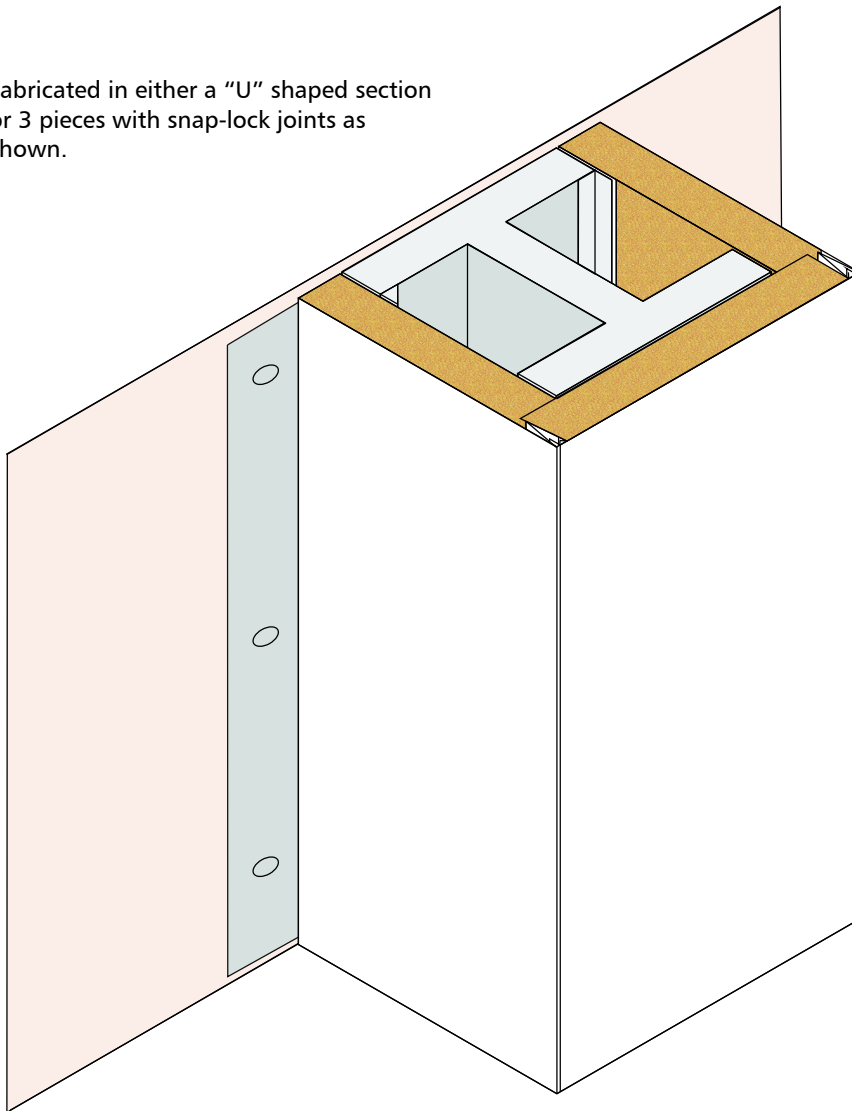

a) Concrete screws at 300mm centres.

b) Apply a bead of intumescent mastic to the flange edge & concrete.

MATERIAL

Metal:

Internal casings
- 0.6mm steel.

Finishes:

Unfinished, spangle galv, plasticol coated, PVF2 coated, powder coated, polyester coated. Various colours available.

Lining:

Spiralite to provide required fire rating.

Fixings:

No fixings supplied, fixings at 300 ctrs.

Noggins:

30mm or lining thickness if greater to be placed at each end and at board joints.

The information contained in Cryotherm data sheets is believed correct at the time of publication. Whilst we will endeavour to keep our publications up to date, readers will appreciate that between publications there may be pertinent changes in the law, or other developments affecting the accuracy of the information provided.

Date of this revision: 25/11/20