

# Spiralite

## General fixing to columns

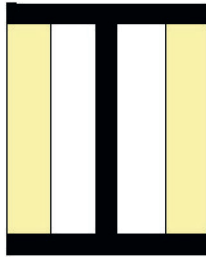
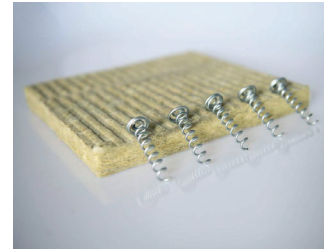

1. Friction fit 100mm wide noggins, flush with flange toes at the top and bottom of the column, also at board joints (4 sided detail).

Note: for two and three sided details fit noggins at 500mm centres.

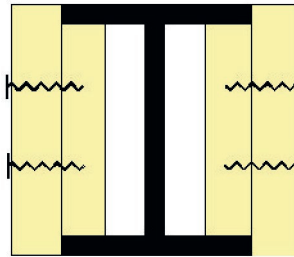

2. Cut web panels equal depth of section and secure on noggins with Spiralite screws at 200mm max centres.

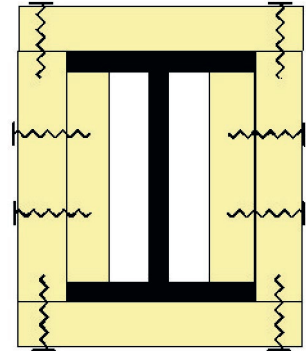

3. Cut flange panels to width of section, plus 2x nominal protection thickness. Secure both edges onto web panels using Spiralite screws at 150mm max.

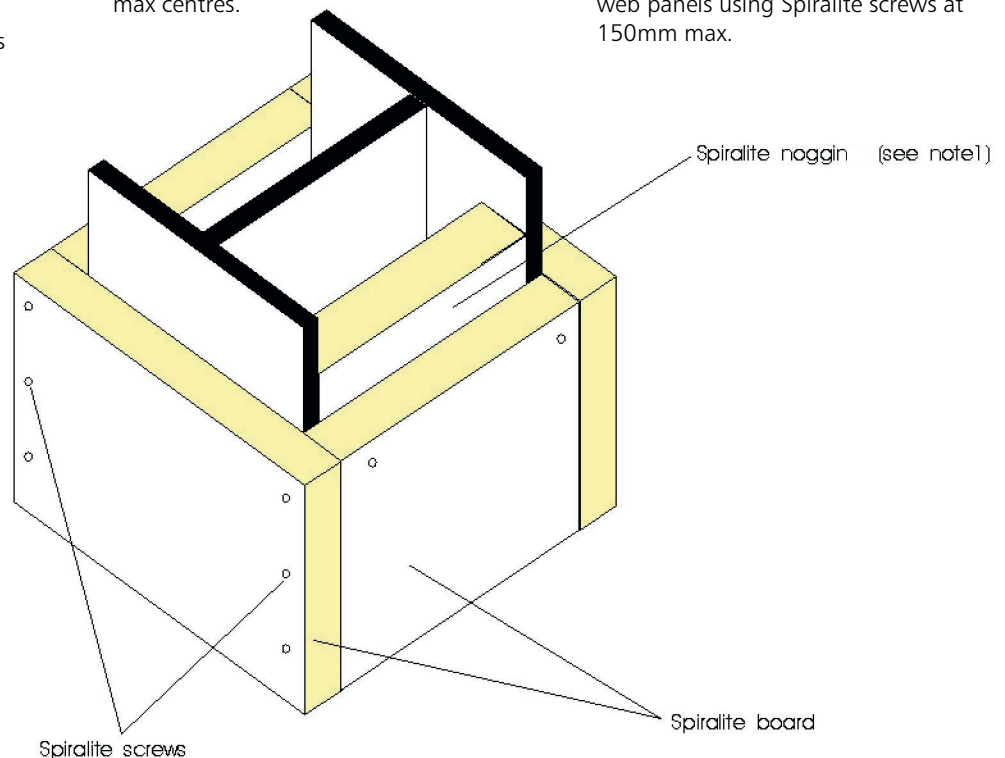

### NOTES

1. Noggin thickness to be same as protection thickness with a minimum of 30mm.
2. Optimum screw length = 2x Protection Thickness minus 5mm, longer screws may be used.
3. No adhesive or filler required.
4. Noggins to be placed at top & bottom of column.

The information contained in Cryotherm data sheets is believed correct at the time of publication. Whilst we will endeavour to keep our publications up to date, readers will appreciate that between publications there may be pertinent changes in the law, or other developments affecting the accuracy of the information provided.

Date of this revision: 01/01/2024