

Glulite

General fixing details to beams

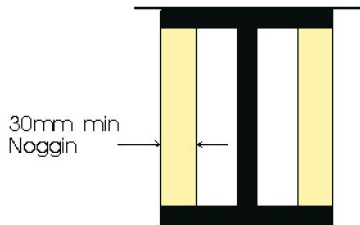

1. Friction fit and glue 100mm wide noggins, flush with flange toes at each end of the beam and at 500mm centres.

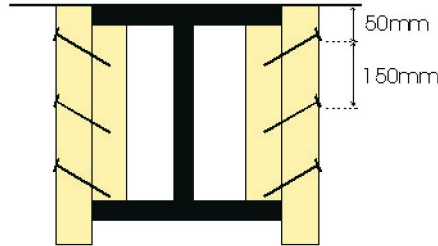

2. Cut side panels equal to depth of section plus nominal thickness of board and secure on noggins with Rockbond adhesive and nails fixed askew at 150mm max centres.

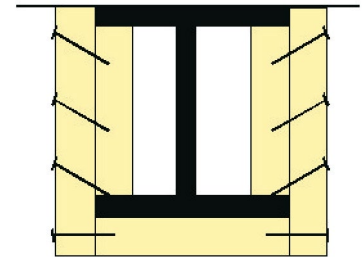

3. Cut soffit panel equal to width of lower flange. Apply Rockbond adhesive to all board to board joints. Secure soffit panel to sides with nails at 450mm max centres, 1/2 board thickness from lower board edge.

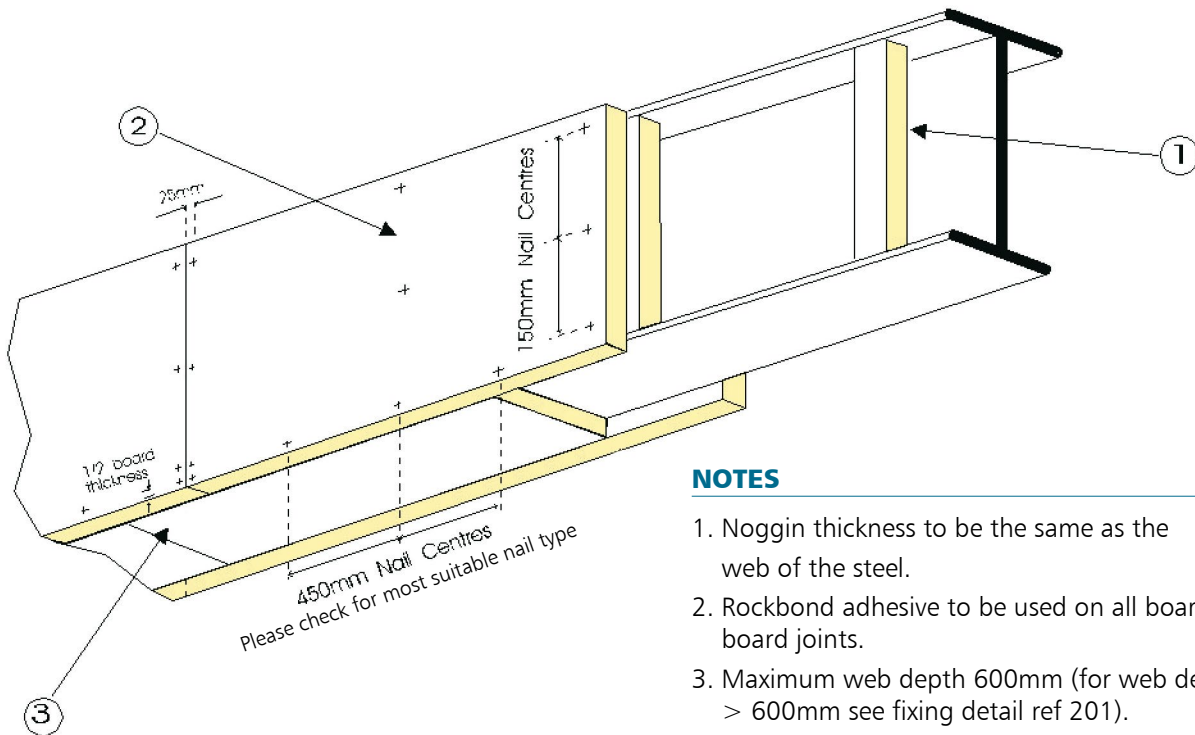

NOTES

1. Noggin thickness to be the same as the web of the steel.
2. Rockbond adhesive to be used on all board to board joints.
3. Maximum web depth 600mm (for web depths > 600mm see fixing detail ref 201).
4. Maximum flange width 315mm (for flange width > 315mm see fixing detail ref 201).
5. Nail length = 2 x protection thickness or protection thickness + web depth minus 5mm if shorter.
6. Please contact us for specific application/fixing

The information contained in Cryotherm data sheets is believed correct at the time of publication. Whilst we will endeavour to keep our publications up to date, readers will appreciate that between publications there may be pertinent changes in the law, or other developments affecting the accuracy of the information provided.

Date of this revision: 25/11/20